

Photoelectric Sensor
BOS 5K-PO-RR10-02
Sn=4000mm
Retroreflective

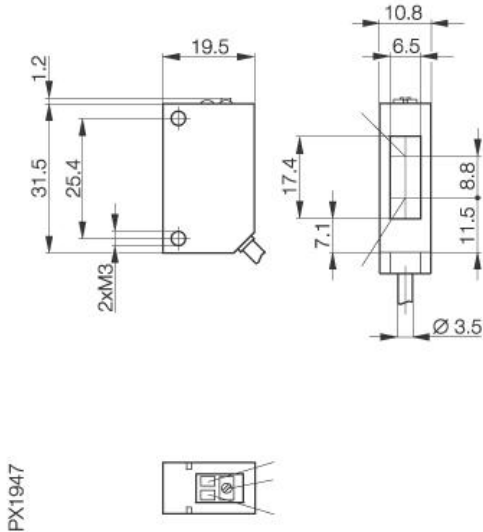

Common Data

Series	5K
Sensortype	Retroreflective
Switching frequency	500 Hz
Rated operating distance Sn in mm	4000
asured operating distance Sa	adjustable
Indication Supply Voltage	yes, green LED
Indication Switching element on	yes, yellow LED
Ambient temperature	-25...+55°C
On-delay	1ms
Off-delay	<0,5ms
Light	Red light, 660nm
Sensitivity Adjustment	Poti 270°
Permissable ambient light	5000 Lux
Output function	light-on

Mechanical Data

Measurements	31,5 x 19,5 x 10,8
Housing material	PC/PBT
Material of sensing face	PMMA
Degree of protection	IP67
Connection	Cable
Weigth	30g
Type of Cable	PVC

Electrical Data

Current	DC
Switching function	normally-closed
Output	PNP
Rated operational voltage Ue	24V DC
Rated operational current Ie	100mA
Supply Voltage	10...30V DC
Frequency of Supply Voltage	DC
No-load supply current	<30mA
Voltage drop	<1,2V
Short protection	yes
Protected against polarity reversal	yes

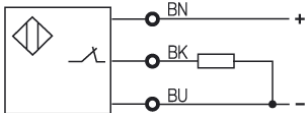

Utilization categories
 Insulation class

Datasheet number:

Definitions see general catalog.
 If not otherwise noted, ratings according to
 IEC 60947-5-2 (DIN EN60947-5-2)

Balluff GmbH
 Schurwaldstrasse 9
 73765 Neuhausen a.d.F.
 Phone (07158) 173-0 Fax (07158) 5010

Datenblatt by CD-ROM - 04/2007

BALLUFF
 sensors worldwide